



Pantera Technical Information

Group: 12 **Article:** 10 **Date:** September 1987
Subject: PARKING BRAKE BLUES
By: John Neal, Pantera Club of Dallas

Back in 1979 one of my minor problems with my recently purchased '74L was the parking brake would not hold my car on my driveway. Close inspection indicated proper operation of lever, arm, roller and cable, but I noticed the left rear clevis was bottomed out against the cable housing hex tube and you could still rotate the rotor with the parking brake applied.

The solution was simple but a little tricky. I cut 1/2" off the hex tube. Sounds easy but you must cut the tube long ways first and cut a channel large enough to slip out the cable when you cut the tube to length. Vise grips and a hacksaw are the only tools required. You need to allow about two hours and please **do not cut your cable.**

The end result was a parking brake that performs perfectly and will hold my car on a 30% grade.

PANTERA CAR PARTS

ILLUSTRATION SECTION 20

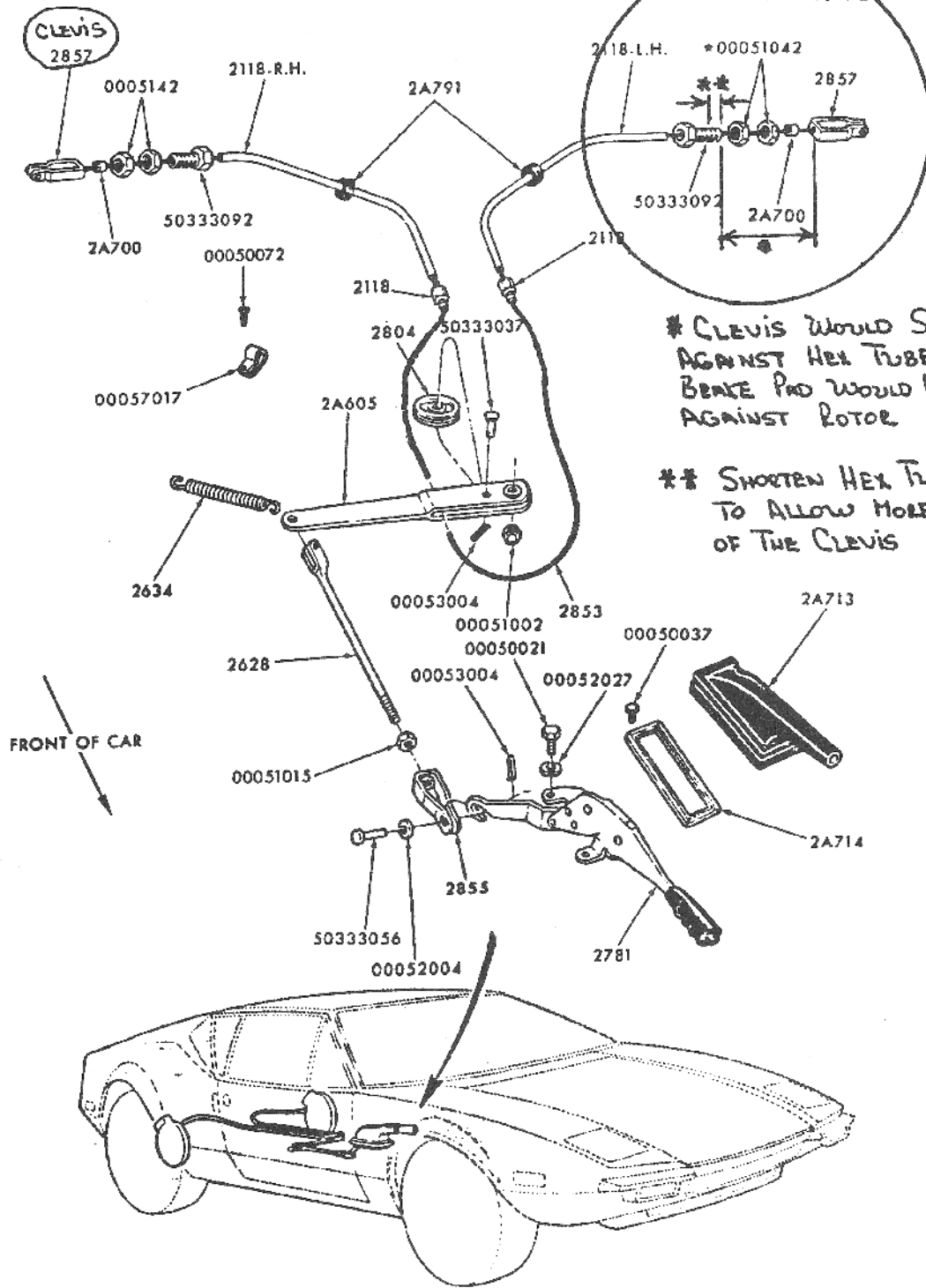

FRONT OF CAR

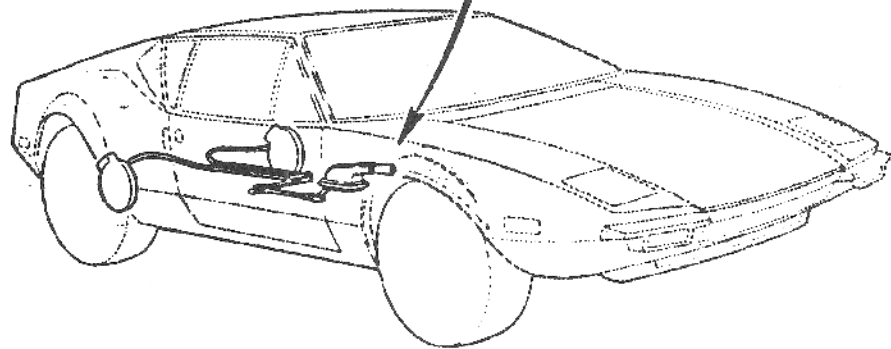

P. 9278

PARKING BRAKE SYSTEM
1971/74 PANTERA